

RITTIUM THERMO 20

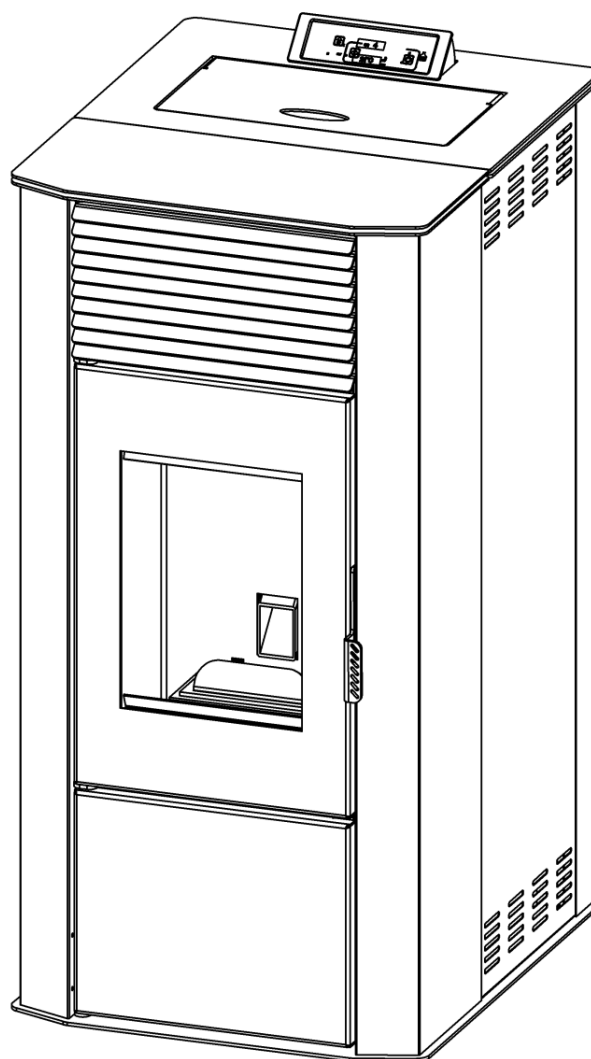

Важно: Преди стартиране на уреда, се уверете, че инсталацията е пълна с вода и всички кранове по системата са отворени. Не се разрешава пускането на уреда ако инсталацията е празна.

| | | |
|--------|----------|----|
| 1. | | 4 |
| 1.1. | | 4 |
| 2. | | 5 |
| 3. | | 6 |
| 4. | | 7 |
| 5. | | 8 |
| 6. | | 11 |
| 6.1. | | 12 |
| 6.2. | | 12 |
| 7. | | 14 |
| 7.1. | | 14 |
| 7.2. | | 15 |
| 8. | | 16 |
| 8.1. | | 16 |
| 8.2. | | 17 |
| 8.2.1. | | 17 |
| 8.2.2. | | 18 |
| 8.2.3. | | 19 |
| 8.2.4. | | 23 |
| 8.3. | | 24 |
| 8.4. | | 25 |
| 8.5. | STAND-BY | 25 |
| 8.6. | | 26 |
| 8.7. | | 27 |
| 8.8. | | 28 |
| 8.9. | | 28 |
| 9. | | 29 |
| 10. | | 30 |
| 11. | | 34 |
| 12. | | 37 |
| 13. | | 38 |
| 14. | | 40 |

3.

1

1

| | | |
|-----|----|------------------|
| / / | kW | 20 / 5 / 15 |
| () | mm | 551 x 751 x 1162 |
| | kg | 215 |
| () | | (Ø 6mm L 30 mm) |
| | mm | Ø 80 |
| | Pa | 12+/- 2 |
| | kg | 40 |
| | V | 230 +/- 15 % |
| | Hz | 50 |
| | W | 55-160 * |
| | W | 400-450 ** |
| | % | 91 |
| / / | kW | 5 / 2 / 3 |
| | kg | 4,7 |
| | kg | 1 |
| 13% | % | 0,02 |
| | °C | 135 |
| | °C | 5-60 |
| | °C | -10 - 60 |
| () | % | 95 |

*

**

(400W),

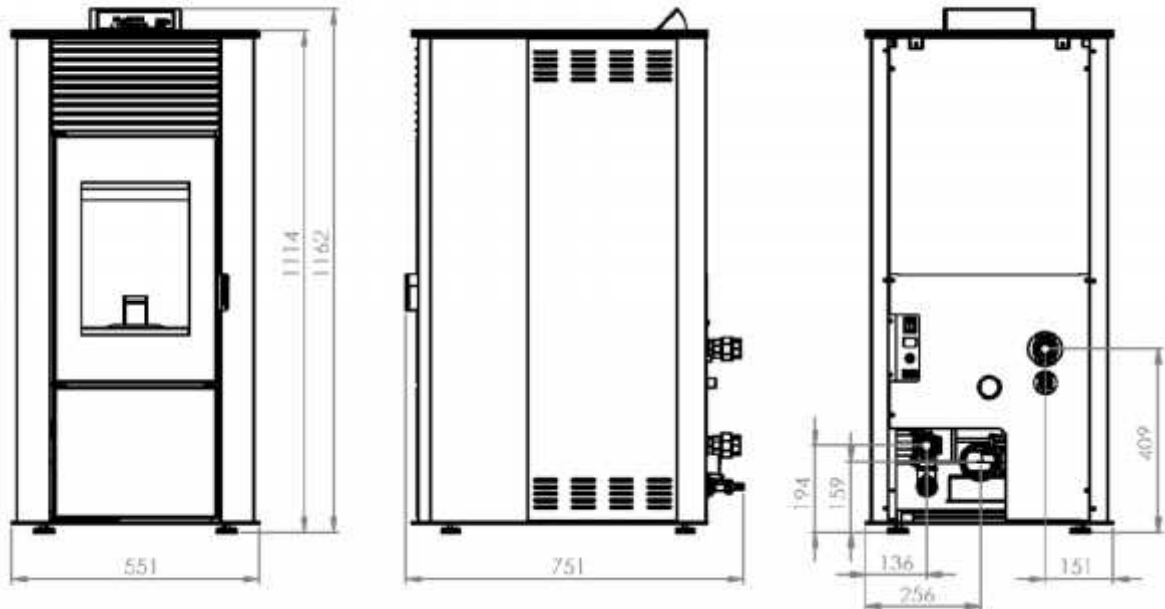

4.

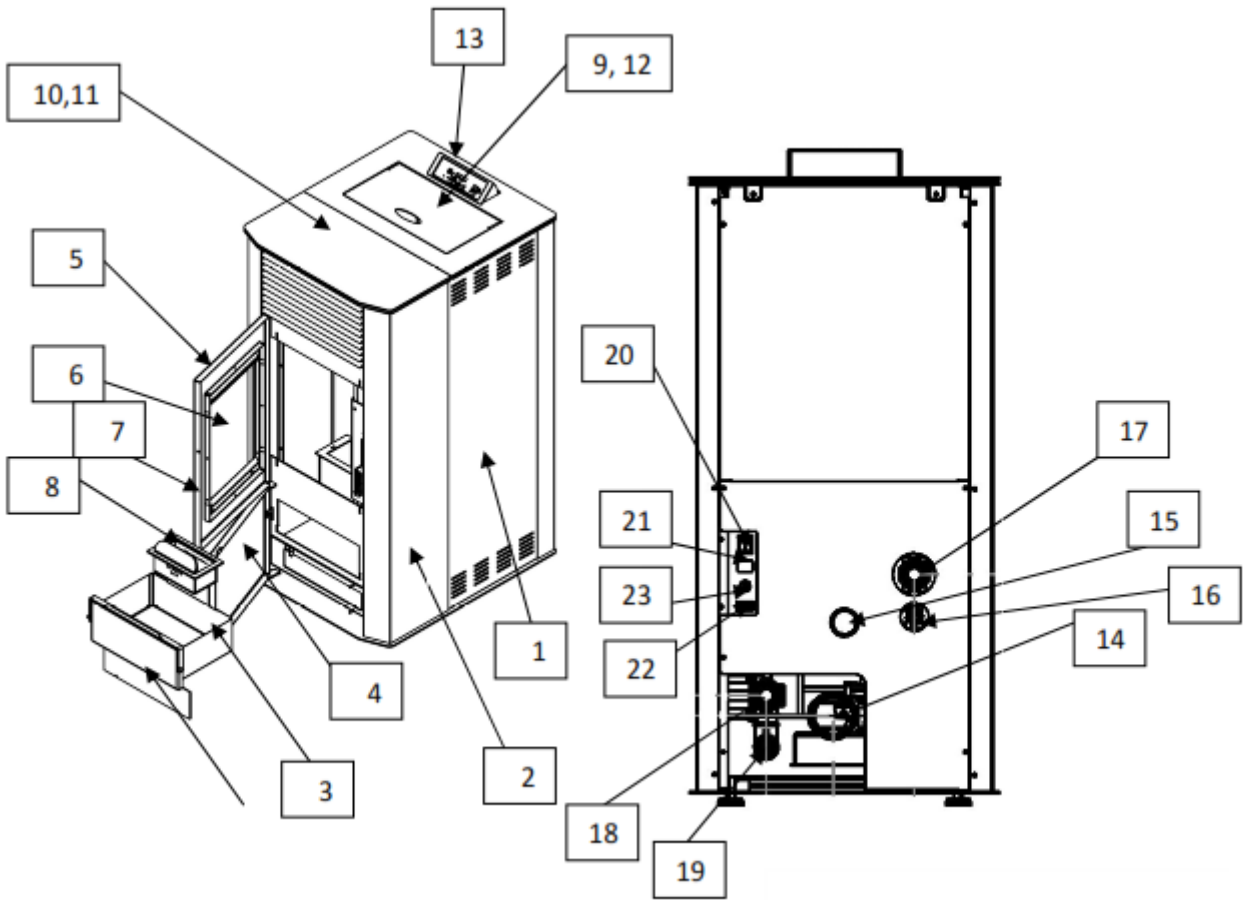

2.

2

- 1.
- 2.
- 3.
- 4.
- 5.
- 6.
- 7.
- 8.
- 9.
- 10.
- 11.
- 12.
- 13.
- 14.
- 15.
- 16.
- 17.
- 18.

19. PIP

20.

21.

22.

23. STB

(RS232)

1"
1"

5.

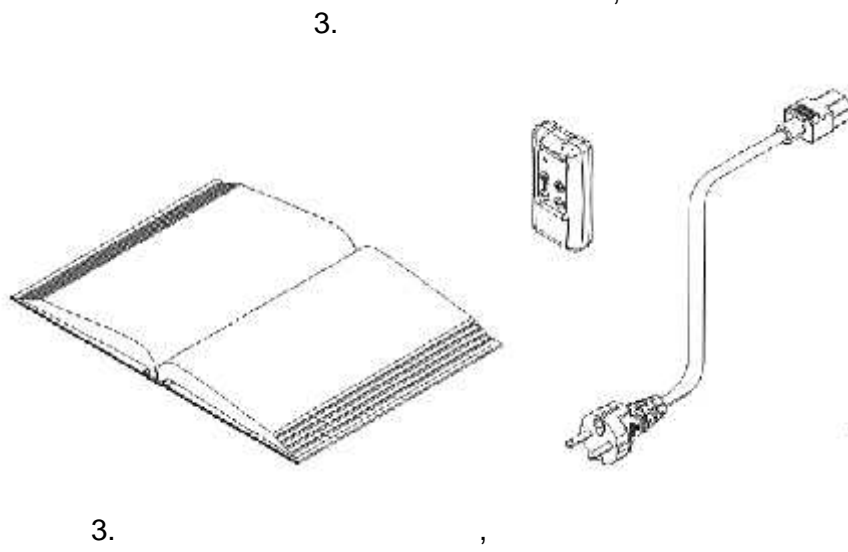

4.

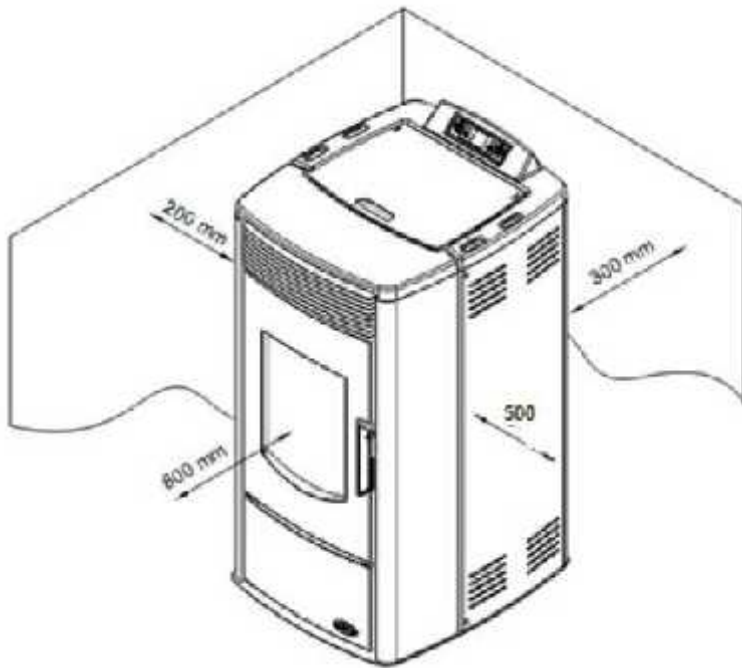

4.

- 1.
- 2.
- 3.
- 4.
- 5.
- 6.
- 7.
- 8.
- 9.
- 10.

230V 50Hz.
(). 5
0.

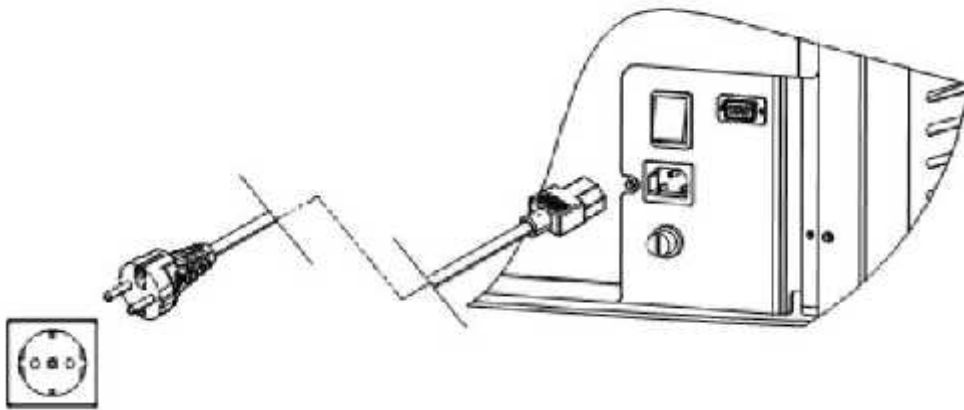

5.

3

6.

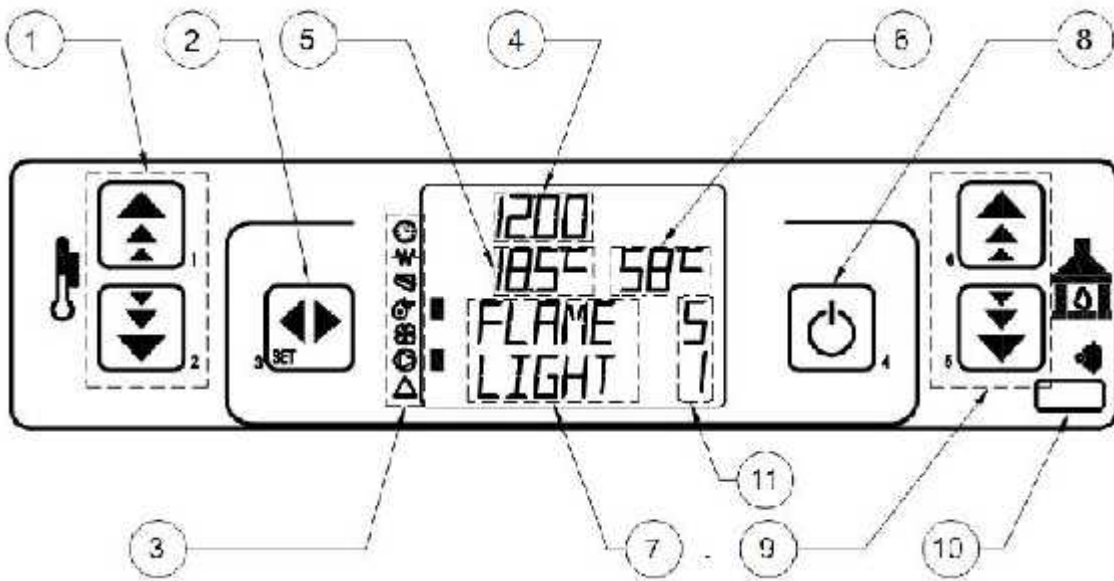

6.

6

6

- 1 2
- 3.
- 4. / /
- 5 6
- 7.
- 8.
- 9.
- 10.
- 11. (- , -
- 12.
- 13.)

6.1.

2.

| | |
|--|-----|
| | () |
| | , |
| | |
| | |
| | |
| | () |

2.

6.2.

12V P23GA.
7.

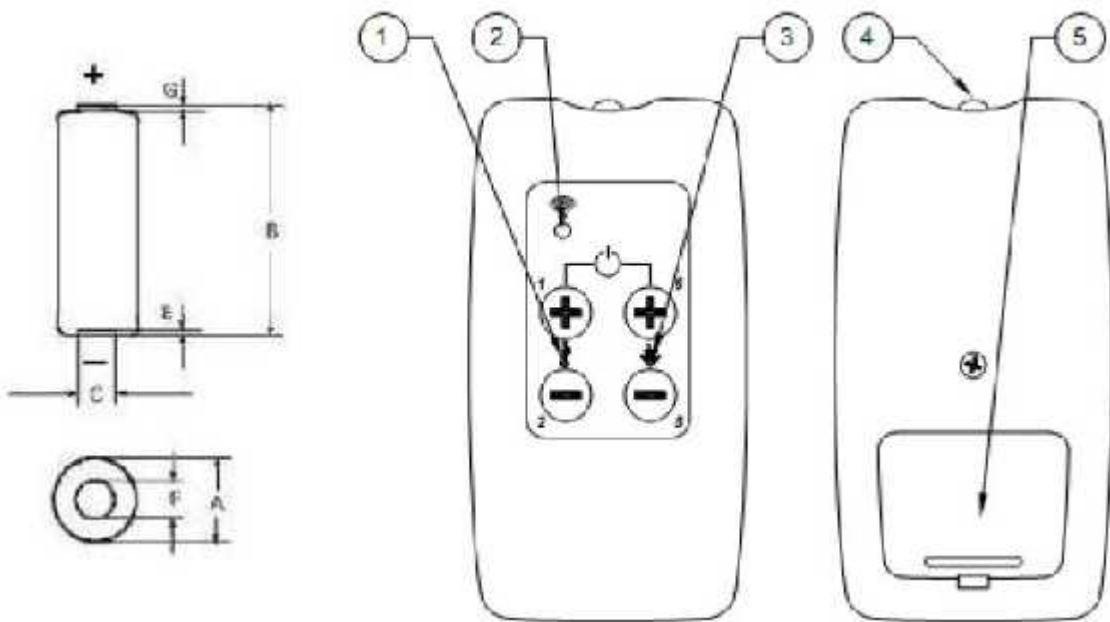

7.

, 2-
, 4-

, 5-

(1-
)

, 3-

7.

1.

7.1.

4.
START.

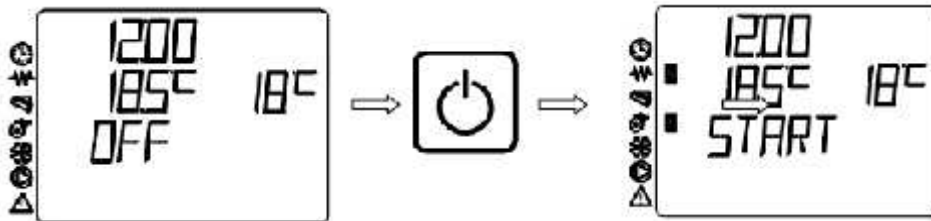

LIGHTER WAIT,

LOAD PELLET.

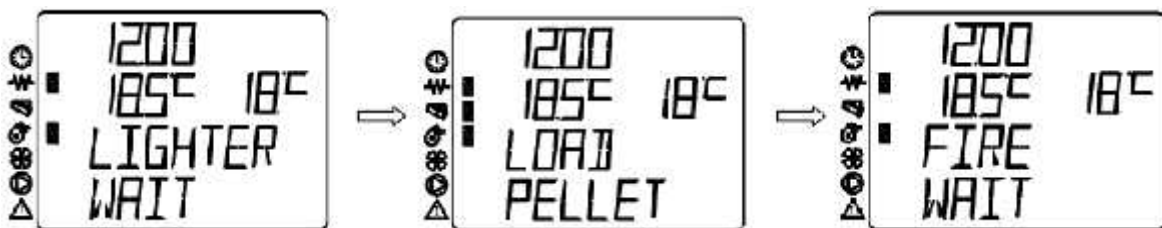

LOAD PELLET FIRE WAIT,
40°

40° 25

FLAME LIGHT,
4

WORK.

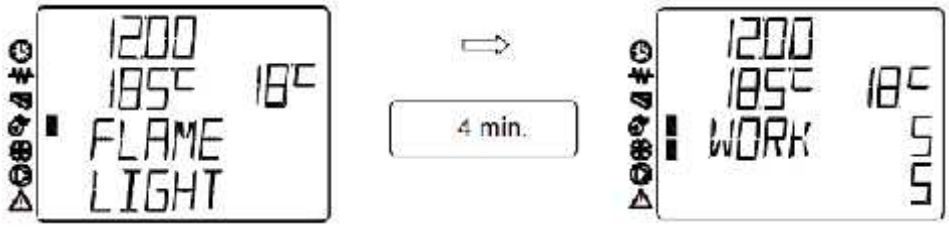

CLEANING FIRE-POT.

CLEANING FINAL.
4
52°
OFF,

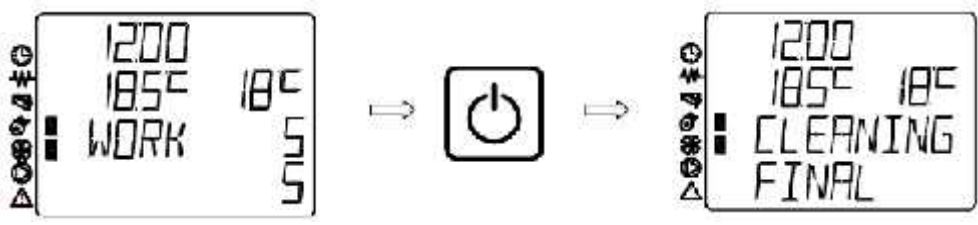

7.2.

2.
1 2
SET TEMP ROOM.
7 40°

6.
1 5.
5 6,
SET OUTPUT.

WORK MODULAT,

1.

1

1 2

SET TEMP WATER.
20 80°

8.

8.1.

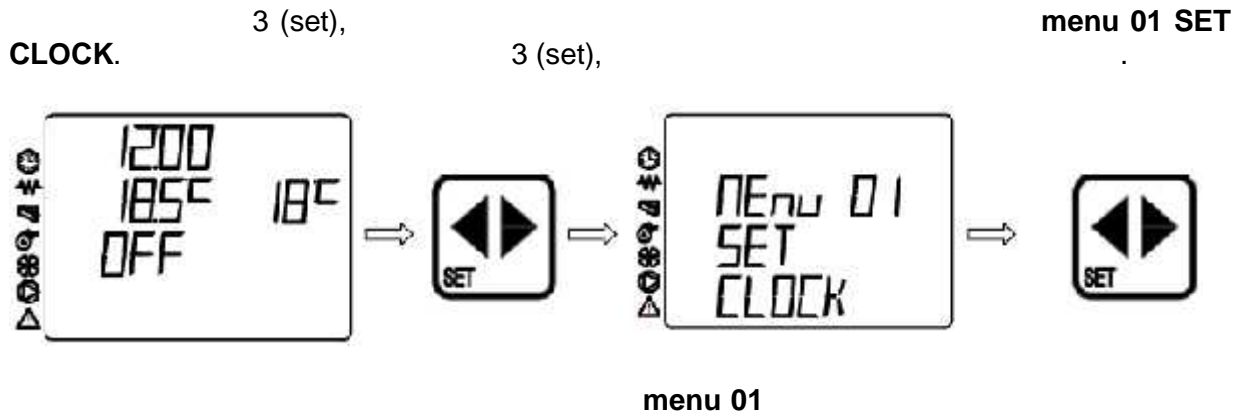

1 2

MONDAY
TUESDAY
WEDNESDA
THURSDAY
FRIDAY
SATURDAY
SUNDAY

5

1 2

| | | | | |
|--|--|--|--|--|
| | | | | |
| | | | | |

6

4.

8.2.

:
:
4 , 2
:
2

8.2.1.

(, ,) . :

3 (set),

menu 01 SET

CLOCK.

5

menu 02 SET CHRONO.

3 (set)

m-2-1 ENABLE CHRONO.

3 (set),

off m-2-1-01 ENABLE CHRONO,

1 2

off on

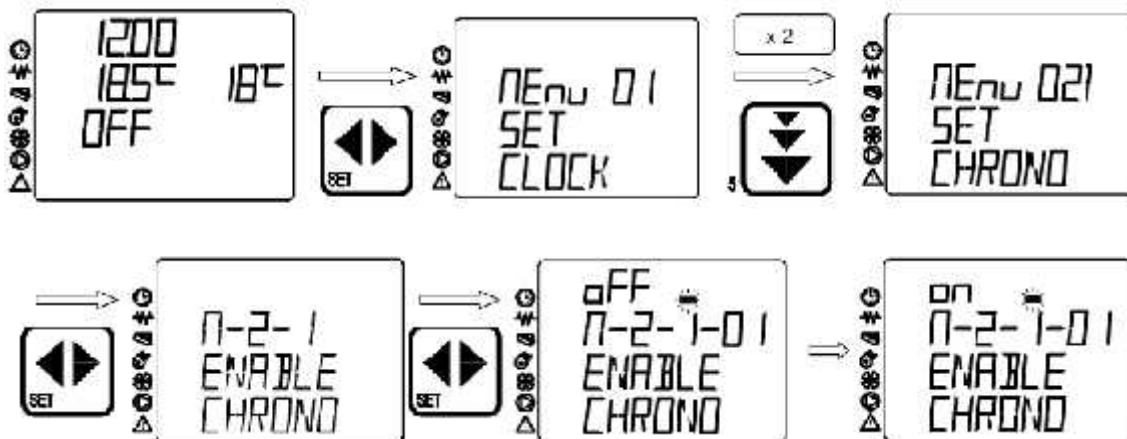

(, ,)

- 1 -
- 2 -
- 3 -
- 4 -

8.2.2.

30

3 (set), menu 01
 SET CLOCK. 5
 menu 02 SET CHRONO. 3 (set)
 m-2-1 ENABLE CHRONO.
 5 m-2-2 PROGRAM DAY.

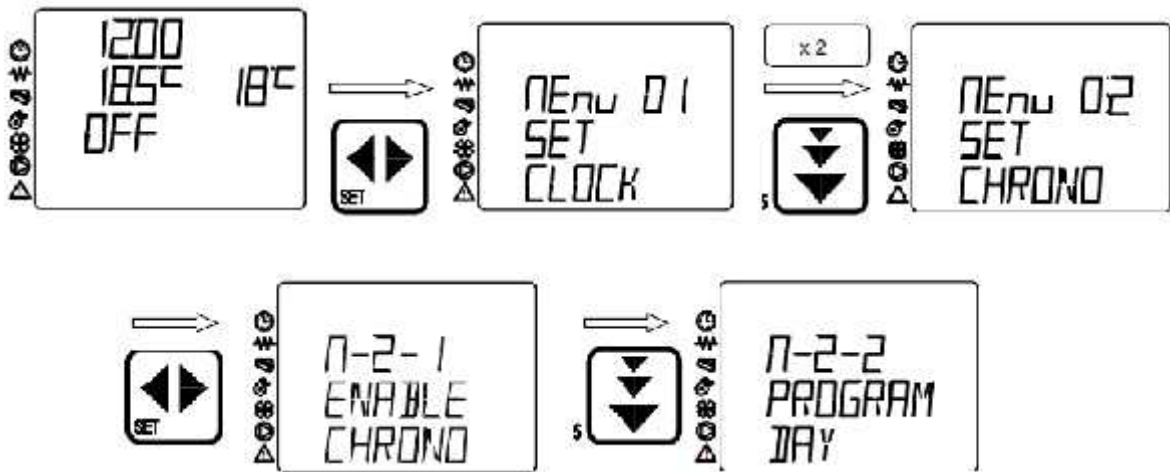

2-2-01 CHRONO DAY. 1 2 3 (set) on, off m-
 5 6 , 1 2
 10
 4.
 : 6 8
 14 22:30

| | |
|----------------------|-------|
| m-3-2-01 CHRONO DAY | on |
| m-3-2-02 START 1 DAY | 06:00 |
| m-3-2-03 STOP 1 DAY | 08:00 |
| m-3-2-04 START 2 DAY | 14:00 |
| m-3-2-05 STOP 2 DAY | 22:30 |

| | | |
|----------------------|-----------------|--|
| | | |
| m-2-2-01 CHRONO DAY | off/on | |
| m-2-2-02 START 1 DAY | off/00:00-23:50 | |
| m-2-2-03 STOP 1 DAY | off/00:00-23:50 | |
| m-2-2-04 START 2 DAY | off/00:00-23:50 | |
| m-2-2-05 STOP 2 DAY | off/00:00-23:50 | |

8.2.3.

:

- 30 .

3 (set), menu 01 SET
CLOCK. 5
menu 02 SET CHRONO. 3 (set)
', m-2-1 ENABLE CHRONO. 5
m-2-3 PROGRAM WEEK.

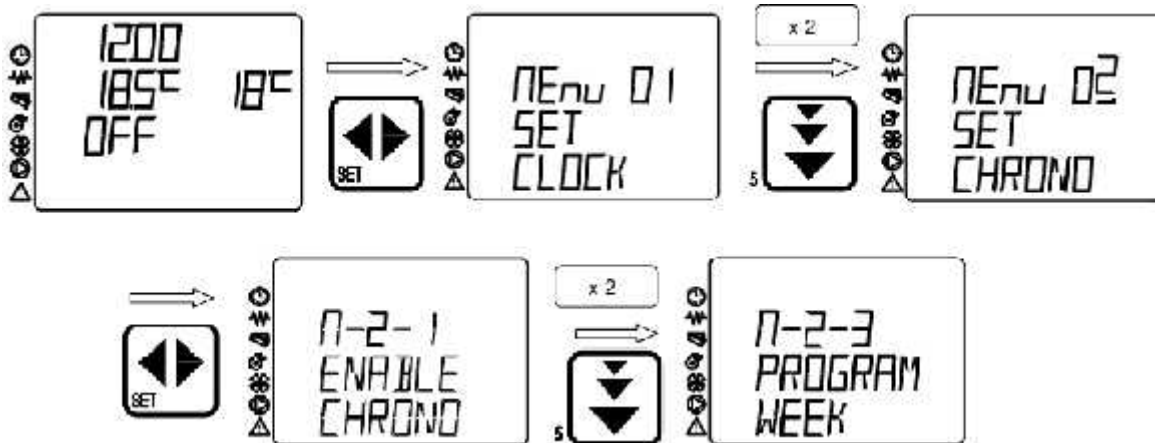

2-3-01 CHRONO WEEKLY. 3 (set) off m-
 1 2 , 1 2
 5 6 ,
 10

| | | |
|------------------------------|--------|--|
| | | |
| m-2-3-01 CHRONO WEEKLY | on/off | |

| | | | |
|--|---|--|---|
| m-2-3-02 START PROG-1 off/00:00-23:50 | m-2-3-03 STOP PROG-1 off/00:00-23:50 | m-2-3-04 MONDAY PROG-1 on/off | m-2-3-05 TUESDAY PROG-1 on/off |
|--|---|--|---|

| | | | |
|---------------------------------------|---------------------------------------|---------------------------------------|---------------------------------------|
| m-2-3-06 WEDNESDA PROG-1 | m-2-3-07 THURSDAY PROG-1 | m-2-3-08 FRIDAY PROG-1 | m-2-3-09 SATURDAY PROG-1 |
| on/off | on/off | on/off | on/off |
| OFF 7-2-3-06 WEDNESDA PROG-1 | OFF 7-2-3-07 THURSDAY PROG-1 | OFF 7-2-3-08 FRIDAY PROG-1 | OFF 7-2-3-09 SATURDAY PROG-1 |
| m-2-3-10 SUNDAY PROG-1 | m-2-3-11 START PROG-2 | m-2-3-12 STOP PROG-2 | m-2-3-13 MONDAY PROG-2 |
| on/off | off/00:00-23:50 | off/00:00-23:50 | off/on |
| OFF 7-2-3-10 SUNDAY PROG-1 | OFF 7-2-3-11 START PROG-2 | OFF 7-2-3-12 STOP PROG-2 | OFF 7-2-3-13 MONDAY PROG-2 |
| m-2-3-14 TUESDAY PROG-2 | m-2-3-15 WEDNESDA PROG-2 | m-2-3-16 THURSDAY PROG-2 | m-2-3-17 FRIDAY PROG-2 |
| off/on | off/on | off/on | off/on |
| OFF 7-2-3-14 TUESDAY PROG-2 | OFF 7-2-3-15 WEDNESDA PROG-2 | OFF 7-2-3-16 THURSDAY PROG-2 | OFF 7-2-3-17 FRIDAY PROG-2 |
| m-2-3-18 SATURDAY PROG-2 | m-2-3-19 SUNDAY PROG-2 | m-2-3-20 START PROG-3 | m-2-3-21 STOP PROG-3 |
| off/on | off/on | off/00:00-23:50 | off/00:00-23:50 |
| OFF 7-2-3-18 SATURDAY PROG-2 | OFF 7-2-3-19 SUNDAY PROG-2 | OFF 7-2-3-20 START PROG-3 | OFF 7-2-3-21 STOP PROG-3 |
| m-2-3-22 MONDAY PROG-3 | m-2-3-23 TUESDAY PROG-3 | m-2-3-24 WEDNESDA PROG-3 | m-2-3-25 THURSDAY PROG-3 |
| off/on | off/on | off/on | off/on |
| OFF 7-2-3-22 MONDAY PROG-3 | OFF 7-2-3-23 TUESDAY PROG-3 | OFF 7-2-3-24 WEDNESDA PROG-3 | OFF 7-2-3-25 THURSDAY PROG-3 |

| | | | |
|--|--|--|--|
| m-2-3-26 FRIDAY PROG-3 off/on | m-2-3-27 SATURDAY PROG-3 off/on | m-2-3-28 SUNDAY PROG-3 off/on | m-2-3-29 START PROG-4 off/00:00-23:50 |
| OFF 7-2-3-26 FRIDAY PROG-3 | OFF 7-2-3-27 SATURDAY PROG-3 | OFF 7-2-3-28 SUNDAY PROG-3 | OFF 7-2-3-29 START PROG-4 |

| | | | |
|---|--|---|--|
| m-2-3-30 STOP PROG-4 off/00:00-23:50 | m-2-3-31 MONDAY PROG-4 off/on | m-2-3-32 TUESDAY PROG-4 off/on | m-2-3-33 WEDNESDA PROG-4 off/on |
| OFF 7-2-3-30 STOP PROG-4 | OFF 7-2-3-31 MONDAY PROG-4 | OFF 7-2-3-32 TUESDAY PROG-4 | OFF 7-2-3-33 WEDNESDA PROG-4 |

| | | | |
|--|--|--|--|
| m-2-3-34 THURSDAY PROG-4 off/on | m-2-3-35 FRIDAY PROG-4 off/on | m-2-3-36 SATURDAY PROG-4 off/on | m-2-3-37 SUNDAY PROG-4 off/on |
| OFF 7-2-3-34 THURSDAY PROG-4 | OFF 7-2-3-35 FRIDAY PROG-4 | OFF 7-2-3-36 SATURDAY PROG-4 | OFF 7-2-3-37 SUNDAY PROG-4 |

: 6 8
 , 5 30 ,
 10
 17 ,
 8 22 .
 23 .

| | |
|--------------------------|-------|
| m-2-3-01 CHRONOWEELY | on |
| m-2-3-02 START PROG-1 | 06:00 |
| m-2-3-03 STOP PROG-1 | 08:00 |
| m-2-3-04 MONDAY PROG-1 | on |
| m-2-3-05 TUESDAY PROG-1 | on |
| m-2-3-06 WEDNESDA PROG-1 | off |
| m-2-3-07 THURSDAY PROG-1 | off |
| m-2-3-08 FRIDAY PROG-1 | on |
| m-2-3-09 SATURDAY PROG-1 | off |
| m-2-3-10 SUNDAY PROG-1 | off |

| | |
|--------------------------|-------|
| m-2-3-11 START PROG-2 | 05:30 |
| m-2-3-12 STOP PROG-2 | 10:00 |
| m-2-3-13 MONDAY PROG-2 | off |
| m-2-3-14 TUESDAY PROG-2 | off |
| m-2-3-15 WEDNESDA PROG-2 | on |
| m-2-3-16 THURSDAY PROG-2 | on |
| m-2-3-17 FRIDAY PROG-2 | off |
| m-2-3-18 SATURDAY PROG-2 | off |
| m-2-3-19 SUNDAY PROG-2 | off |

| | | |
|----------|-----------------|-------|
| m-2-3-20 | START PROG-3 | 17:00 |
| m-2-3-21 | STOP PROG-3 | 22:00 |
| m-2-3-22 | MONDAY PROG-3 | on |
| m-2-3-23 | TUESDAY PROG-3 | on |
| m-2-3-24 | WEDNESDA PROG-3 | on |
| m-2-3-25 | THURSDAY PROG-3 | on |
| m-2-3-26 | FRIDAY PROG-3 | on |
| m-2-3-27 | SATURDAY PROG-3 | off |
| m-2-3-28 | SUNDAY PROG-3 | off |

| | | |
|----------|-----------------|-------|
| m-2-3-29 | START PROG-4 | 08:00 |
| m-2-3-30 | STOP PROG-4 | 23:00 |
| m-2-3-31 | MONDAY PROG-4 | off |
| m-2-3-32 | TUESDAY PROG-4 | off |
| m-2-3-33 | WEDNESDA PROG-4 | off |
| m-2-3-34 | THURSDAY PROG-4 | off |
| m-2-3-35 | FRIDAY PROG-4 | off |
| m-2-3-36 | SATURDAY PROG-4 | on |
| m-2-3-37 | SUNDAY PROG-4 | on |

8.2.4.

30

3 (set), menu 01 SET
 CLOCK. 5
 menu 02 SET CHRONO. 3 (set)

m-2-1 ENABLE CHRONO. 5
 m-2-4 PROGRAM WEEK-END.

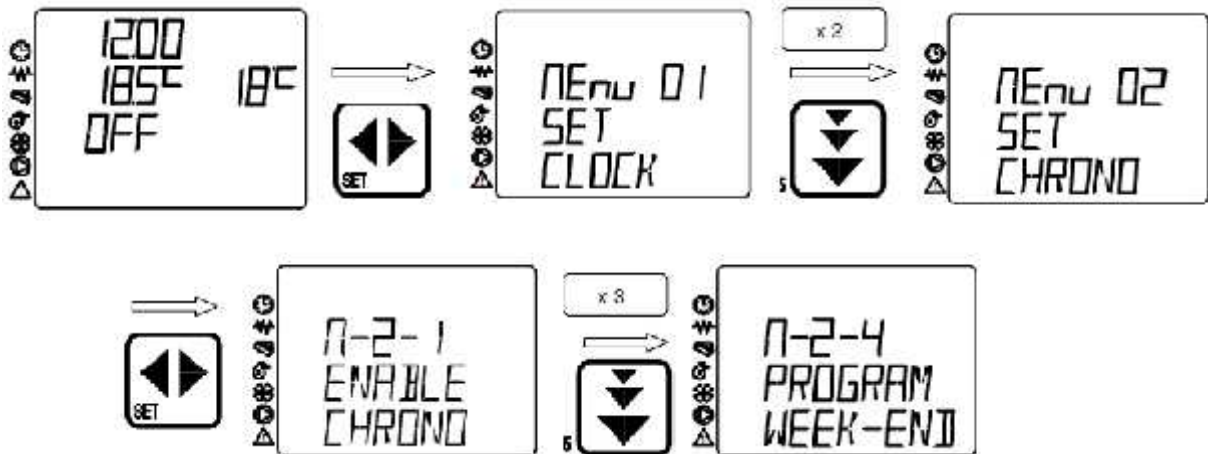

2-4-01 CHRONO WEEK-END. 3 (set) off m-
 1 2 1 2
 5 6 ,
 10
 4.

: 20 8 23 17 , 30 .

| | |
|-------------------------------|-------|
| m-2-4-01 CHRONO WEEK- END | on |
| m-2-4-02 START 1 WEEK- END | 08:00 |
| m-2-4-03 STOP 1 WEEK- END | 17:00 |
| m-2-4-04 START 2 WEEK- END | 20:00 |
| m-2-4-05 STOP 2 WEEK- END | 23:30 |

8.3.

5 3 (set),
 menu 01 SET CLOCK.
 menu 03 SELECT LANGUAGE.
 3 (set)
 menu 03 ENGLISH.

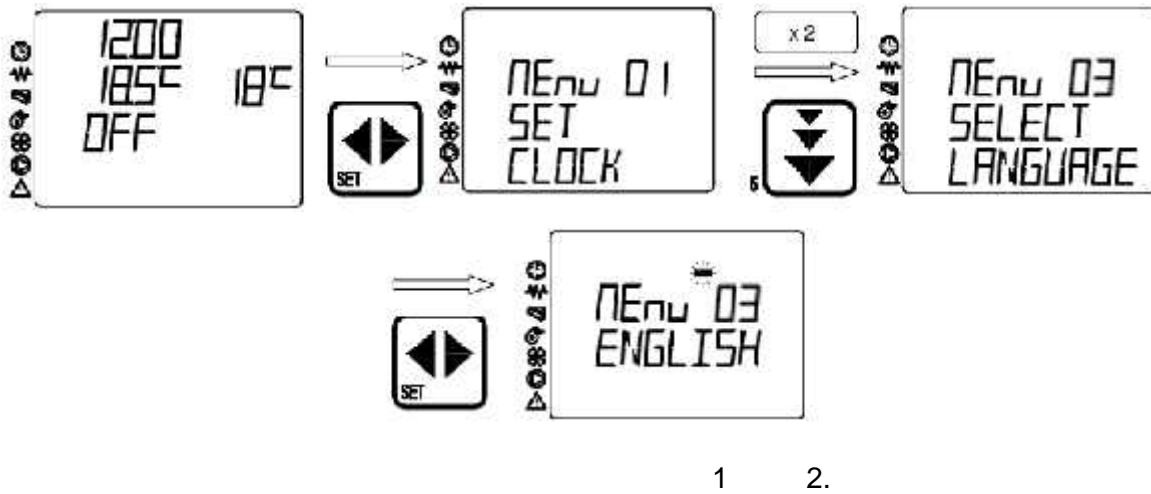

| | | | |
|--|--|--|--|
| | | | |
|--|--|--|--|

4.

8.4.

3 (set),
 menu 01 SET CLOCK. 5
 menu 04 CHOOSE SEASON. 3 (set)



1 2.

| | |
|--|--|
| | |
|--|--|

4.

WAIT COOLING.

8.5.

STAND-BY

STAND-BY

STAND-BY.

2°

2°

STAND-BY

2°

STAND-BY

3

(set)

menu 01 ADJUST BLOWERS.

menu 05 MODE

STAND-BY.

5,

3 (set)

1 2



| STAND-BY | STAND-BY |
|----------|----------|
| | |

4.

STAND-BY,



8.6.

BLOWERS. 3 (set) menu 01 ADJUST
 menu 06 MODE BUZZER. 5, 3 (set)
 1 2



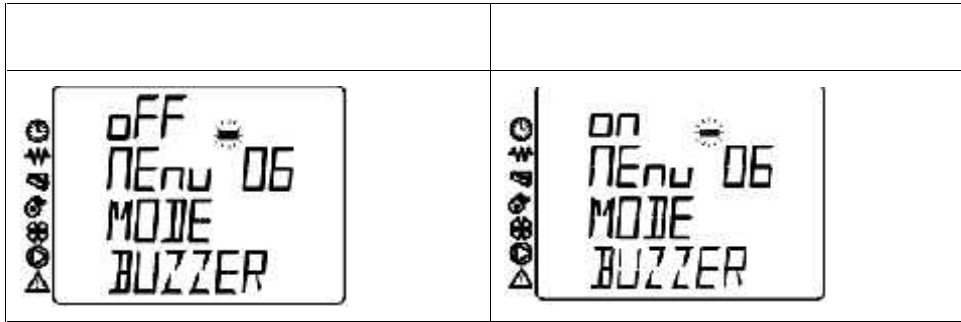

4.

8.7.

Alarm 6,
 menu 01
 3 (set),
 ADJUST BLOWERS.
 menu 07 LOAD INITIAL.
 menu 07 P1 TO LOAD,
 5,
 3 (set)
 off
 1,
 45

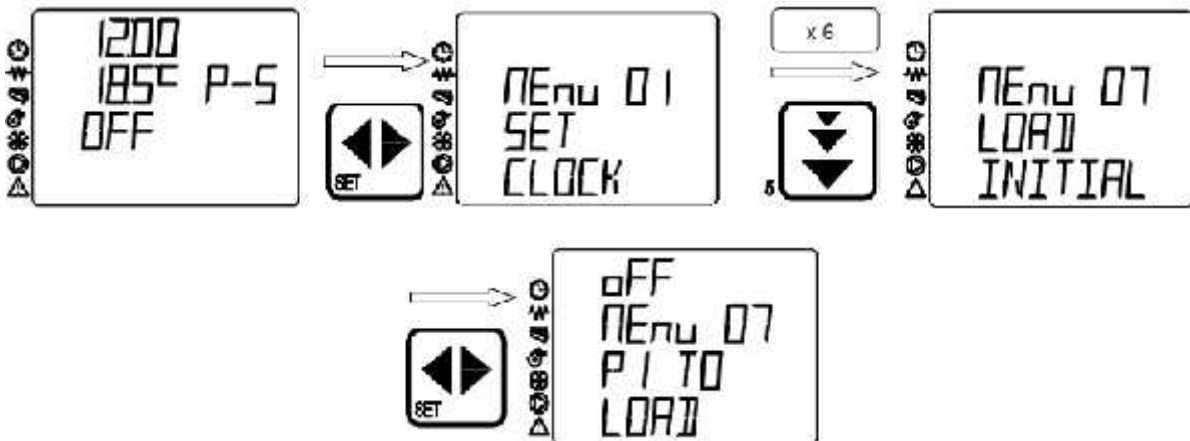

90

4.

8.8.

3 (set), menu 01
ADJUST BLOWERS. menu 08 STATE STOVE. 5, menu 01



3 (set)

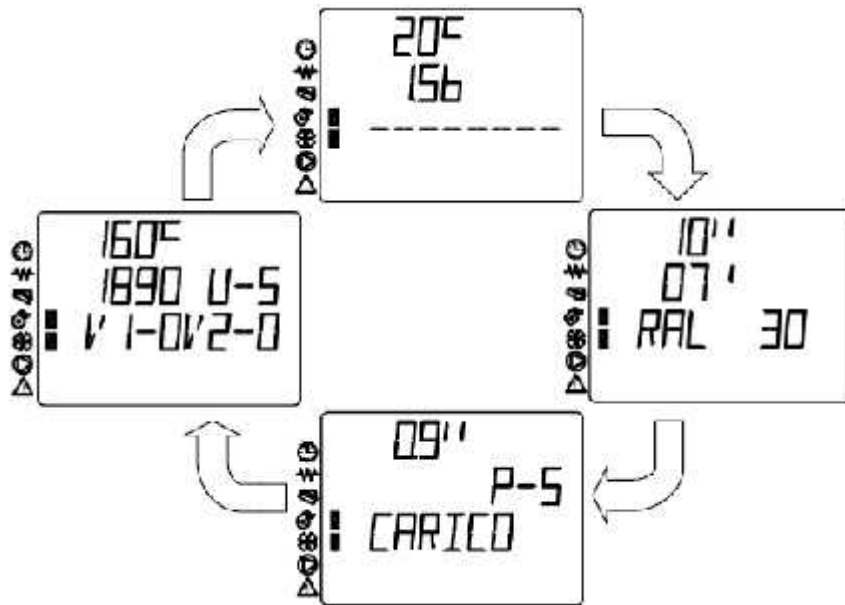

4

8.9.

9.

() .

1,

2,

5,

6,

10.

AL1 BLACK OUT ALLARME ATTIVO.

AL2 SONDA FUMI,

2

373°

HOT EXHAUST.

EXHAUST,

280°

HOT

280°

AL3 SMOKE HOT.

FAILURE,

AL 4 FAN
ALLARME ATTIVO.

2 -

000.

AL 5 NO LIGHTIN-
ALLARME ATTIVO,

AL 5
155°C
NO
LIGHTIN-

150°C
ALLARME
ATTIVO

25

40°

2.

60

**AL 6 NO PELLET,
MEMORIA ALLARME,**

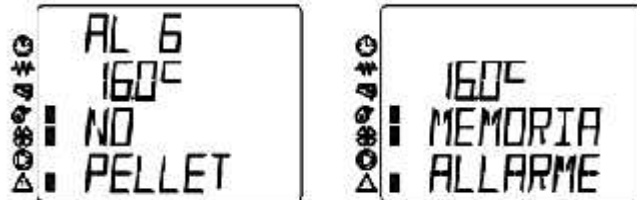

4
8.7.

**AL 7 SAFETY THERMAL,
ALLARME ATTIVO,**



(2)

(1)

FAILURE DEPRESS,
ATTIVO,

AL 8
ALLARME

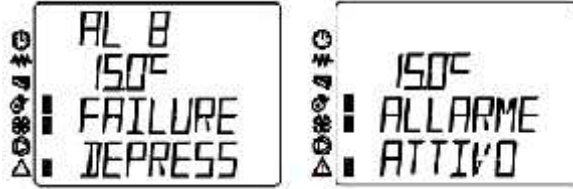

00.0°

0°

11.

0.

).

- 30

(

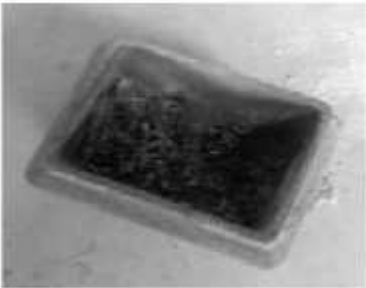

4-

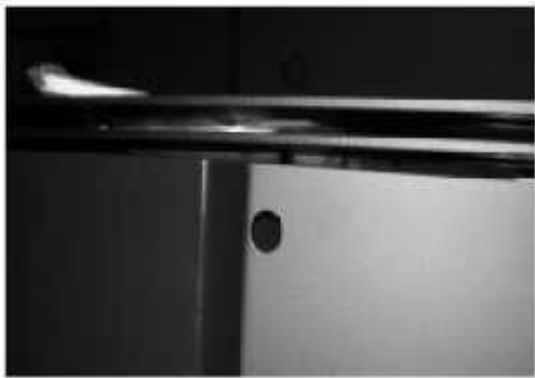

4-

12.

TIM SISTEM

- 45
45

24

TIM SISTEM

(,)

(,)

/

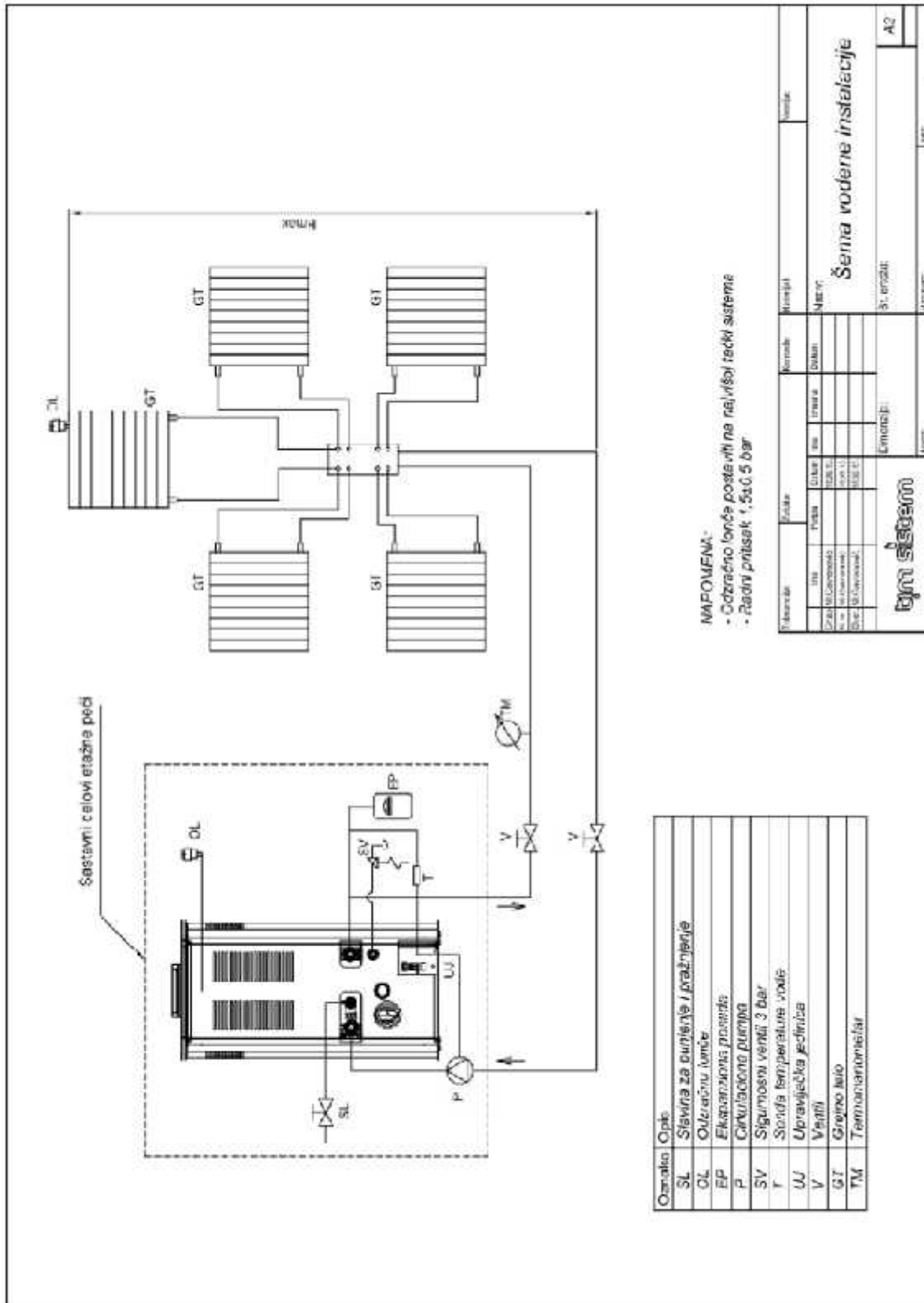

NAPOMENA:
 - Održavno čišćenje posla viti na najvišjoj tački sistema
 - Radni pritisak 1,5a.c. 5 bar

| Oznaka | Opis |
|--------|-----------------------------------|
| SL | Slavinja za puhtenje / pražnjenje |
| OL | Održavno čišćenje |
| EP | Ekspanzijski posuda |
| P | Cirkulaciona pumpa |
| SV | Sigurnosni ventil 3 bar |
| T | Sonda temperature vode |
| UJ | Upravljačka jedinica |
| V | Vajtili |
| GT | Grejno telo |
| TM | Termostatski ventil |

| Šifra | Ime | Adresa | Grad | Država | Projektant | Verzija |
|--------------------------------|-----|--------|------|--------|------------|---------|
| 01 | 01 | 01 | 01 | 01 | 01 | 01 |
| Šema vodene instalacije | | | | | | |
| Emisija: | | | | | | A2 |

| | |
|----|---|
| | |
| SL | |
| OL | |
| EP | |
| P | |
| SV | 3 |
| T | |
| UJ | |
| V | |
| GT | |
| TM | |

:

-

1,5 +/- 0,5

14.

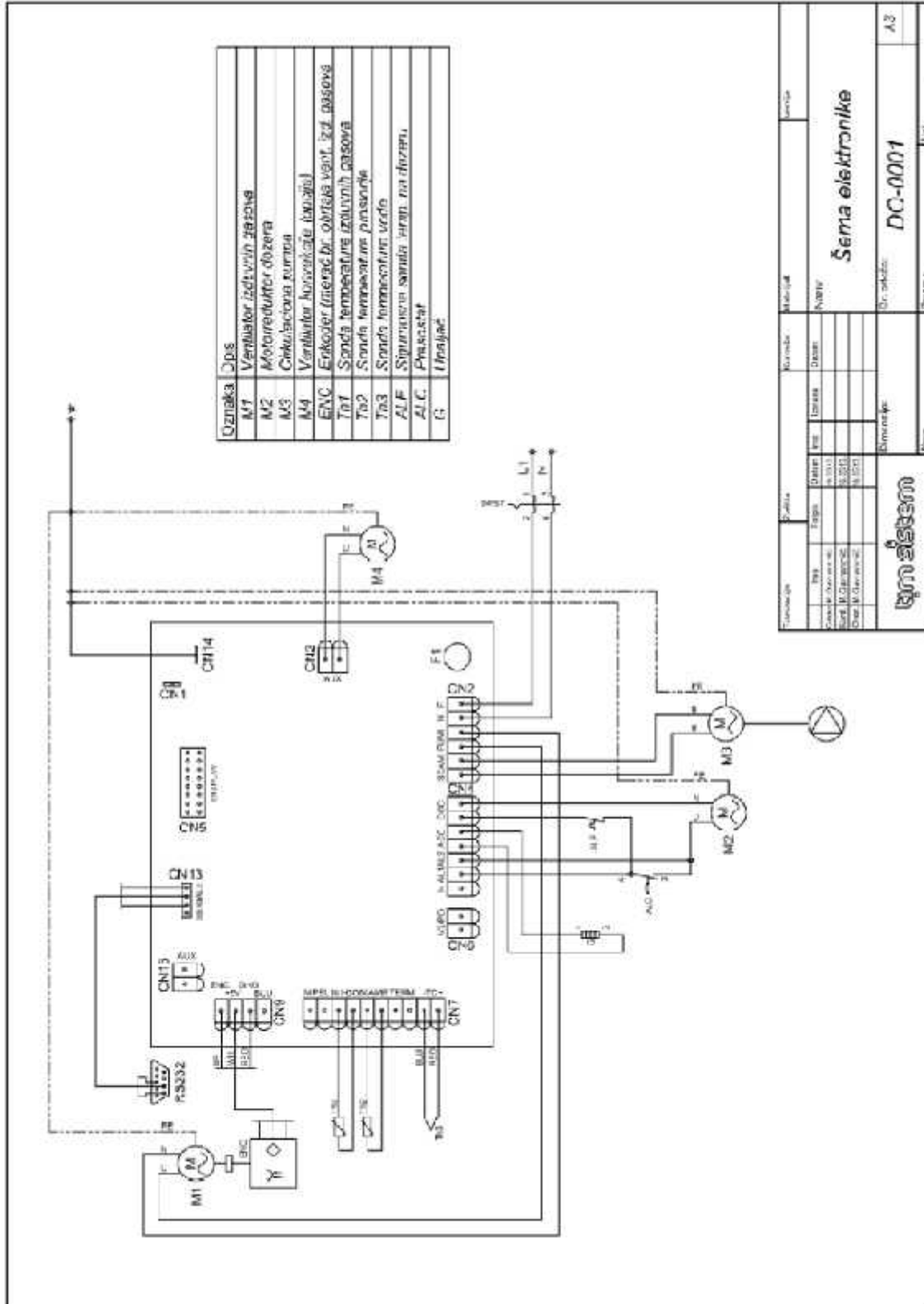

| | |
|-----|-----|
| | |
| M1 | |
| M2 | |
| M3 | |
| M4 | () |
| ENC | () |
| Th1 | |
| Th2 | |
| Th3 | |
| ALF | |
| ALC | |
| G | |